

Service Hub low level Backfitting (By Barnwood) manufactured from 18mm MDF. All external and internal faces laminated and decorated as shown on Elevation. All doors fitted with Hafele Inset Handle, Zinc Alloy, Length 109 mm, Height 56 mm, Vienne Matt Chrome Art. no. 151.35.208. Top to be formed with a 18mm MDF substrate with 40mm solid Oak lippings finished to match Egger Sante Fe with a 3mm solid surface inlay Ref: White pebble E3 236. All Signage by XMO.

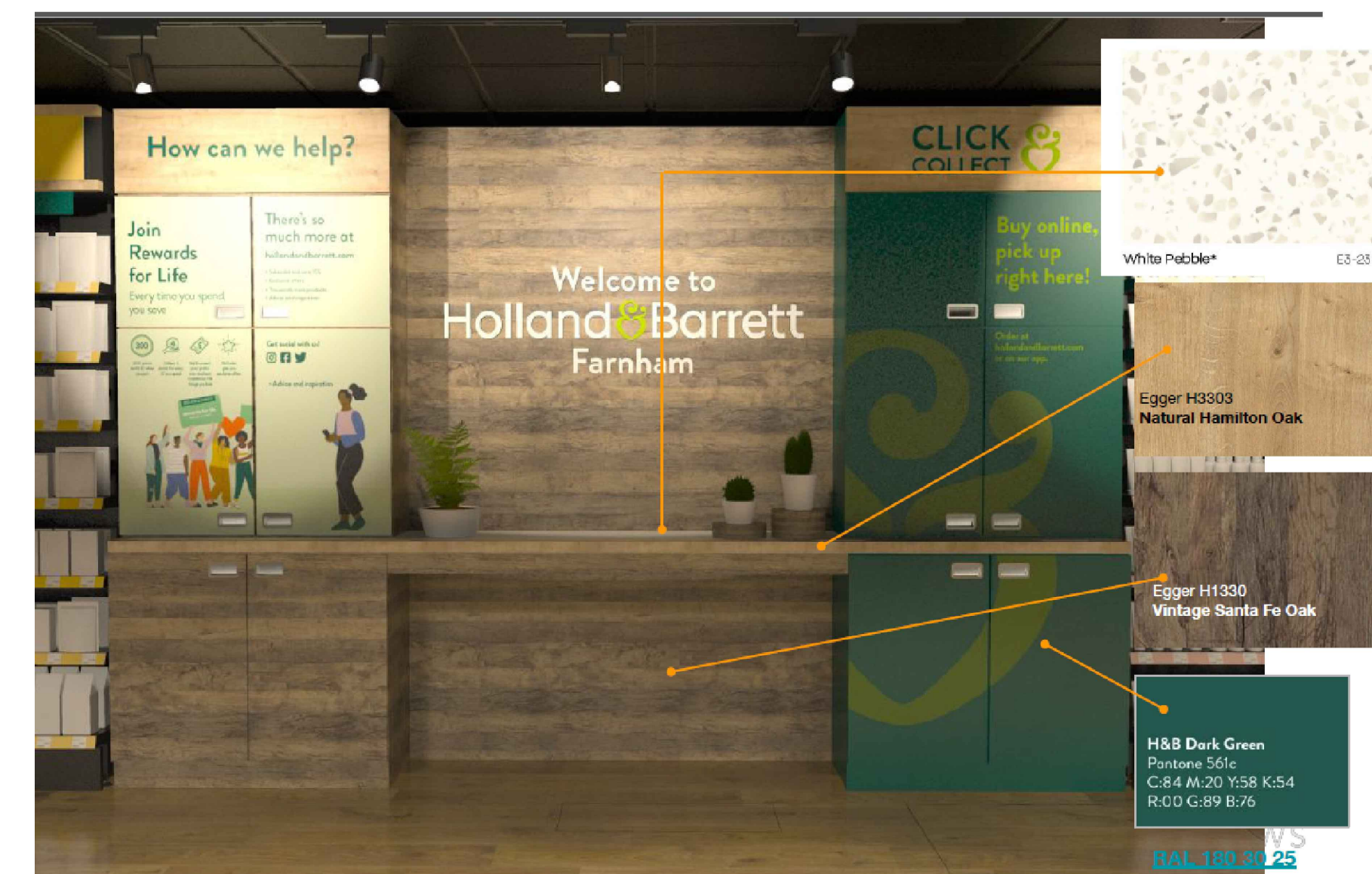
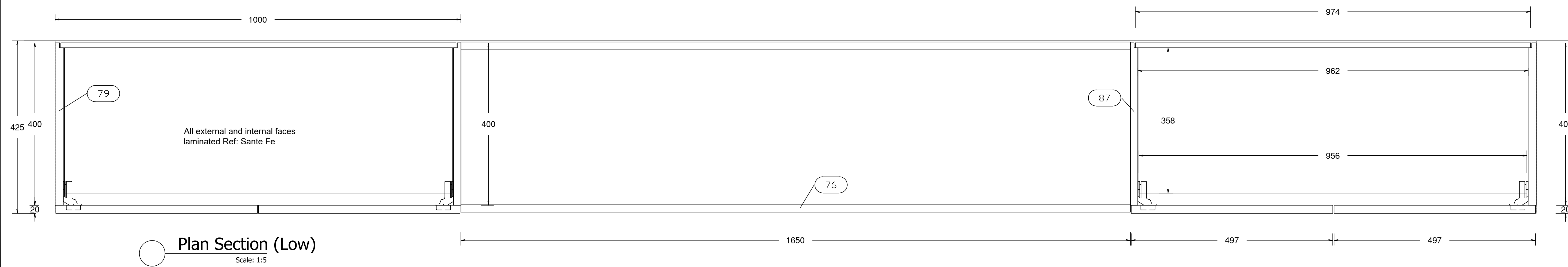
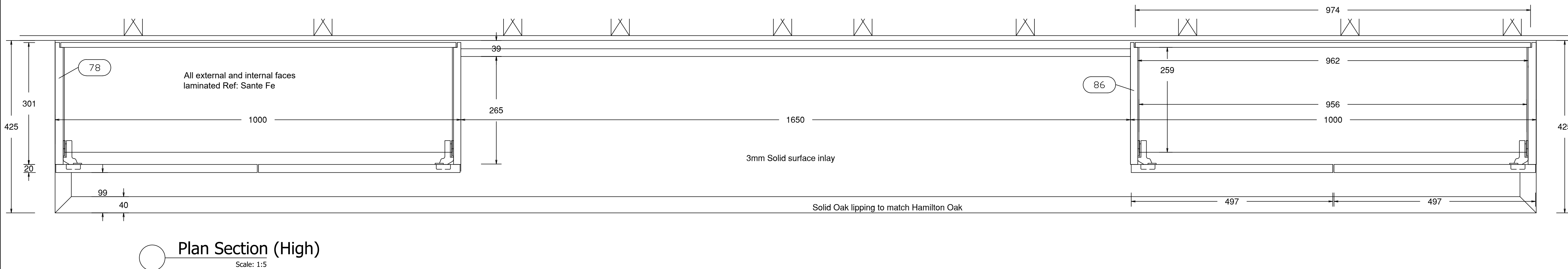
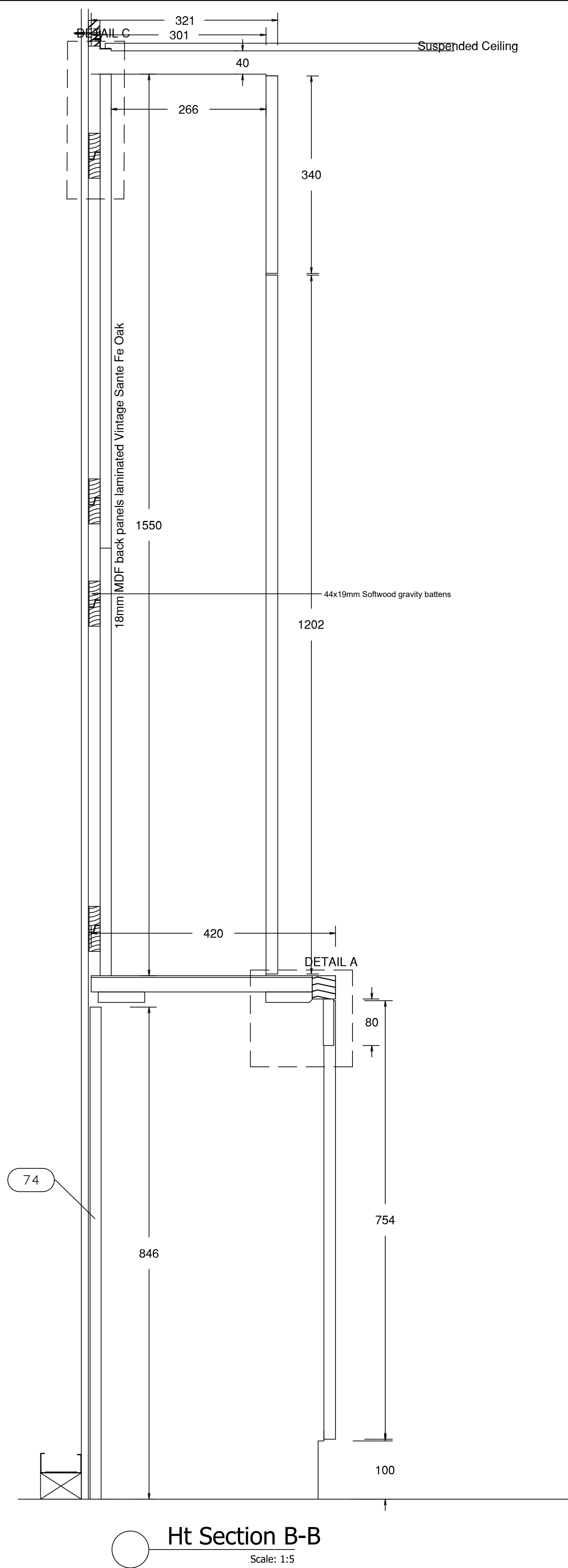

Revisions		
Reference	Date	
A Revised following re design	25.08.20	
V6.7 (25.08.20)		
B Revised following comments (26.08.20)	27.08.20	
C Ht Revised (27.08.20)	27.08.20	

This drawing is the property of Barnwood Shopfitting Limited. At all times it must not be copied or passed to a third party without written consent.

Figured dimensions to be read in preference to scaled.

Status	Approval
Client	H&B
Contract	5a, West St Farnham
Drawing Title	Proposed Service Hub
Date	04.05.20
Drawn By	AS
Check Ref	AS
Revision	C
Scale	As Shown
Drawn By	ay

Barnwood Shopfitting

203 Barnwood Rd Gloucester, GL4 3HS

Phone: (01452) 614134 Fax: (01452) 372933

Web: www.barnwoodshopfitting.com Email: mail@barnwoodshopfitting.com

A0